

Ground Floor Security Layout
 1 : 100

LEGEND:

IDENTIFIER
 DRAWING REVISION WHEN DEVICE ADDED

01-A VIDEO SURVEILLANCE POINT REFERENCE

MULTI-SENSOR 360 CAMERA

PAN, TILT, ZOOM CAMERA

STATIC CAMERA SHOWING FIELD OF VIEW FOR A 720P CAMERA:
 OBS = OBSERVE (15%R)
 REC = RECOGNITION (30%R)
 ID = IDENTIFICATION (60%R)
 REFER TO BE EN 62676 FOR FURTHER INFORMATION

DOOR LOCKING ARRANGEMENTS

A CARD READER FOR INGRESS HANDLED (FREE) EGRESS ELECTRONIC LOCKING DEVICE MONITORED ELECTRONIC LOCK

B CARD READER FOR INGRESS PUSH TO EXIT FOR EGRESS ELECTRONIC LOCKING DEVICE ON EACH LEAF BREAK GLASS UNIT

OTHER

DC DOOR CONTROLLER

LOCK PSU POWER SUPPLY FOR ELECTRIC LOCK

CR CARD READER

IC VIDEO DOOR ENTRY PANEL

ICM VIDEO / AUDIO MONITOR

WR WIRELESS RECEIVER

PS MAGNETIC POSITION SWITCH

D DATA POINT

- ATTACK RATED DOUBLE LEAF DOORS TO BE PROTECTED WITH A TYPE 1 LOCK TESTED AS A COMPLETE SYSTEM, WITH THE OTHER LEAF TO BE LOCKED DOWN WITH A SHOOT-BOLT. BOTH DOORS SHOULD HAVE DOOR POSITION MONITORING.
- ALL CAMERA FIELDS OF VIEW ARE BASED ON 720P CAMERAS TO REPRESENT HOW THE IMAGE WILL BE VIEWED ON A SCREEN. THIS VIEW APPLIES TO CAMERAS WITH HIGHER RESOLUTIONS.

Rev.	Date	Description	Dwn/Chk/Apr
P02	Feb/21	Updated Stage 4 Issue	TT
P01	Jan/20	Stage 4 Issue	TT

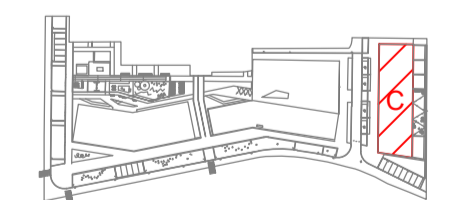

S4 - Suitable For Stage Approval

60607981

Ground Floor Security Layout Block C

BF0037-ACM-C-GF-DR-Y-0001

This drawing has been prepared for the use of AECOM's client. It may not be used, modified, reproduced or relied upon by third parties, except as agreed by AECOM or as required by law. AECOM accepts no responsibility, and denies any liability whatsoever, to any party that uses or relies on this drawing without AECOM's express written consent. Do not scale this document. All measurements must be obtained from the stated dimensions.