

- LEGEND:**
- IDENTIFIER  
DRAWING REVISION WHEN DEVICE ADDED
  - 01-A VIDEO SURVEILLANCE POINT REFERENCE
  - MULTI-SENSOR 360 CAMERA
  - PAN, TILT, ZOOM CAMERA
  - STATIC CAMERA SHOWING FIELD OF VIEW FOR A 720P CAMERA:  
OBS = OBSERVE (15%R)  
REC = RECOGNITION (30%R)  
ID = IDENTIFICATION (60%R)  
REFER TO BE EN 62676 FOR FURTHER INFORMATION
  - DOOR LOCKING ARRANGEMENTS**
  - A → CARD READER FOR INGRESS  
HANDLED (FREE) EGRESS  
ELECTRONIC LOCKING DEVICE  
MONITORED ELECTRONIC LOCK
  - B → CARD READER FOR INGRESS  
PUSH TO EXIT FOR EGRESS  
DOOR CONTACT ON EACH LEAF  
ELECTRONIC LOCKING DEVICE ON EACH LEAF  
BREAK GLASS UNIT
  - OTHER**
  - DC DOOR CONTROLLER
  - LOCK PSU POWER SUPPLY FOR ELECTRIC LOCK
  - CR CARD READER
  - IC VIDEO DOOR ENTRY PANEL
  - ICM VIDEO / AUDIO MONITOR
  - WR WIRELESS RECEIVER
  - PS MAGNETIC POSITION SWITCH
  - D DATA POINT

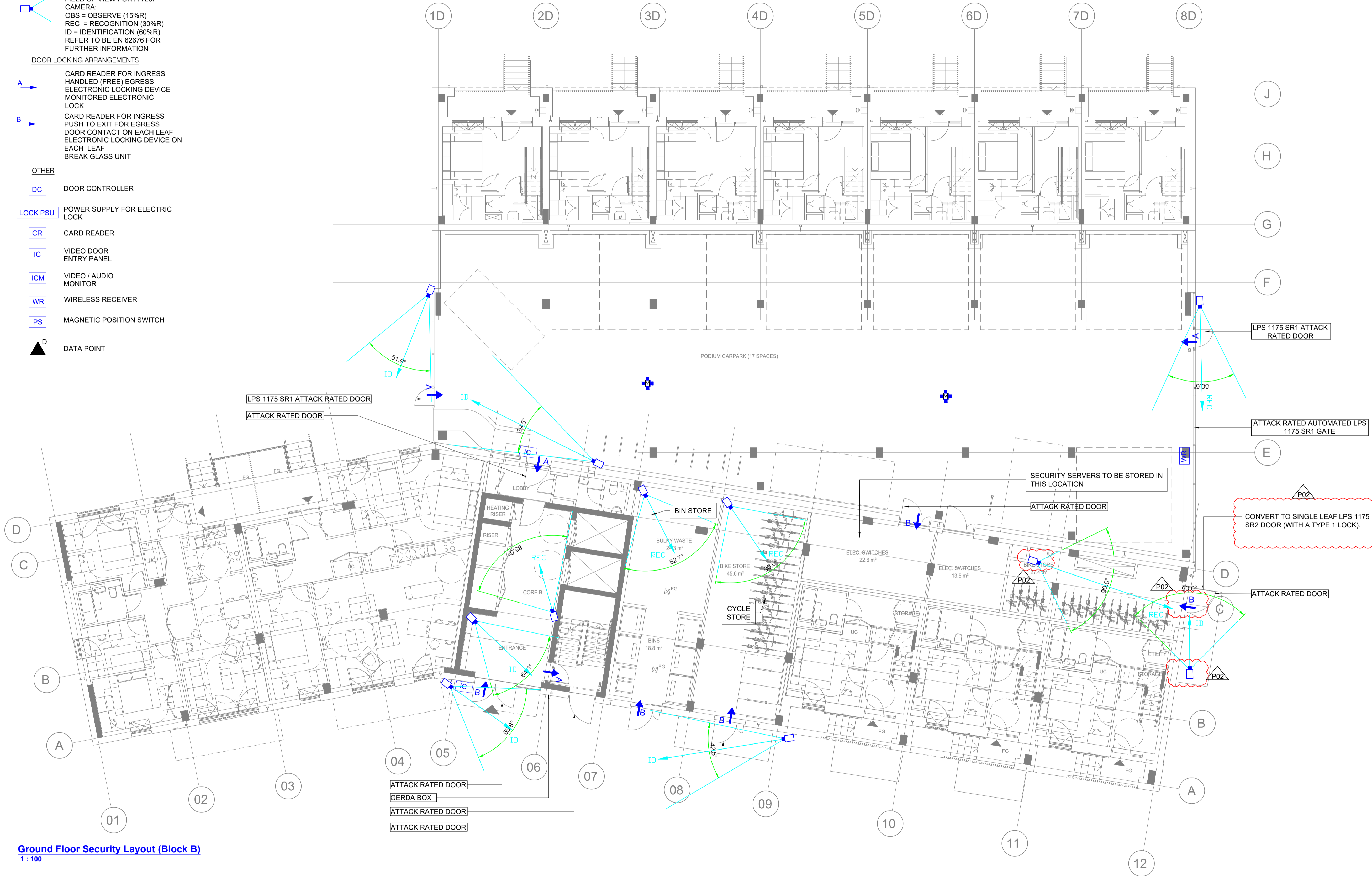

**Ground Floor Security Layout (Block B)**  
 1 : 100

1. ATTACK RATED DOUBLE LEAF DOORS TO BE PROTECTED WITH A TYPE 1 LOCK TESTED AS A COMPLETE SYSTEM, WITH THE OTHER LEAF TO BE LOCKED DOWN WITH A SHOOT-BOLT. BOTH DOORS SHOULD HAVE DOOR POSITION MONITORING.
2. ALL CAMERA FIELDS OF VIEW ARE BASED ON 720P CAMERAS TO REPRESENT HOW THE IMAGE WILL BE VIEWED ON A SCREEN. THIS VIEW APPLIES TO CAMERAS WITH HIGHER RESOLUTIONS.

Rev.	Date	Description	TT
P02	Feb'20	Updated Stage 4 Issue	TT
P01	Jan'20	Stage 4 Issue	TT
			Drm/Chk/Apr

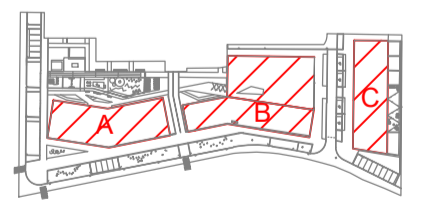

This drawing has been prepared for the use of AECOM's client. It may not be used, modified, reproduced or relied upon by third parties, except as agreed by AECOM or as required by law. AECOM accepts no responsibility, and denies any liability whatsoever, to any party that uses or relies on this drawing without AECOM's express written consent. Do not scale this document. All measurements must be obtained from the stated dimensions.